



# EZ-TRAP<sup>®</sup>

U.S. PATENT NUMBERS 5,069,042 5,522,229

**THE TRAP  
EXPERTS**

## Model EZT-626

### Combination Pack

**EZT-226: SLIP FIT CLOSE-COUPLED  
CONDENSATE OVERFLOW SWITCH**

**EZT-113B: 3/4" ECONOMY  
CONDENSATE TRAP**

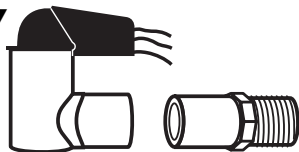

EZT-226

©2004

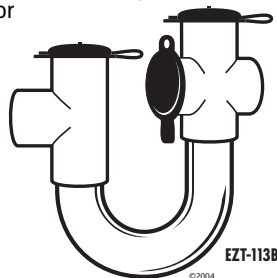

EZT-113B

©2004

#### CONTENTS

##### EZT-226:

- 1 - Float Switch Assembly
- 1 - Terminal Cover
- 1 - 1"×3/4" Slip Street Ell
- 1 - 3/4" Male Threaded Adaptor
- 1 - 48" Cable
- 1 - Red/Blue Label

##### EZT-113B:

- 1 - 3/4" Blow Molded EZ-Trap<sup>®</sup>
- 1 - 3/4" Cross
- 3 - 3/4" Red Caps
- 1 - 3/4" Tee
- 1 - Yellow Cleaning Label
- 1 - Cleaning Brush

#### EZ-TRAP WARRANTY

The manufacturer disclaims all implied and express warranties, including the implied warranty of merchantability and the implied warranty of fitness for a particular purpose, except as follows:

The EZ-Trap condensate trap or overflow switch purchased by you is unconditionally warranted to be free from defects in material and workmanship under normal use for a period of five (5) years from date of purchase, providing it is installed and operated strictly in accordance with manufacturer's installation instructions.

If the product is found to be defective or otherwise fails in normal use, you may return it for replacement. All freight charges for the return of the product shall be borne by you. The manufacturer will pay outgoing freight charges for the replacement product.

Defective products returned to EZ-Trap prepaid will be repaired or replaced free of charge. Replacement product will, to the extent such product is then available in manufacturer's inventory, be of similar type, color and kind. Manufacturer retains the right to substitute product if replacement product does not conform in terms of color, type and specifications to the original product, if no longer available.

This warranty does not cover replacement labor or any cost, claim or incident to any defect nor does it cover any consequential damages. The sole liability of the manufacturer under this warranty is limited to the replacement of defective product. Product damaged by improper use, accident, neglect, alteration, abuse or improper installation is excluded from this warranty.

#### EZ-TRAP INC.

3 Kellogg Court, Unit 10 Edison, NJ 08817  
phone: 732-248-8066 fax: 732-248-8068  
e-mail: info@eztrap.com web: www.eztrap.com

626 INSTALL 7/04



IND. CONT. EQ.

UL<sup>®</sup> listing applies to EZT-226 only

# Model EZT-626



## INSTALLATION INSTRUCTIONS

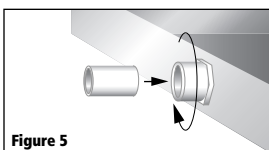
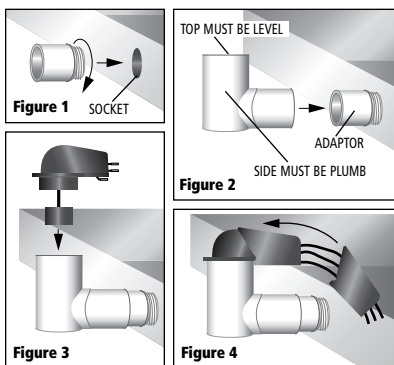

Figure 5

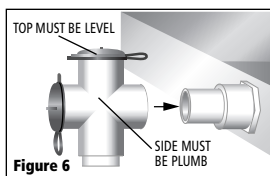

Figure 6

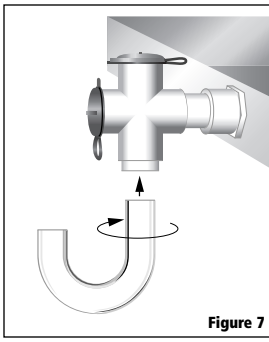

Figure 7

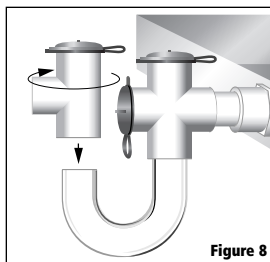

Figure 8

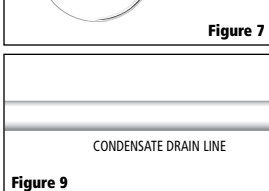

Figure 9

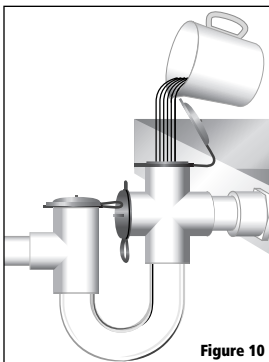
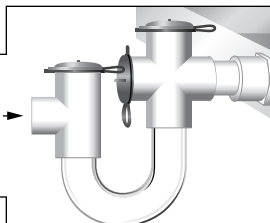

Figure 10

Figure 11

### EZT-226 – Overflow Switch

1. Screw adaptor into overflow outlet on drain pan (Figure 1).
2. Glue Ell onto adaptor. Ell **MUST BE PLUMB.** (Figure 2).
3. Press fit Float Switch into 1" opening at top of Ell. **DO NOT USE GLUE.** (Figure 3).
4. Turn off power at main panel before opening unit and working on electrical system.
5. Install inline fuse to protect 24V circuit if unit is not already fused.
6. Connect wiring to Float Switch following wiring diagram.
7. Slip Terminal Cover over wires and snap onto Switch housing (Figure 4). Complete wiring connections following wiring diagram.
8. Check that actuator arm is connected to float and that float moves freely inside Ell.
9. Test system for proper operation by lifting float.
10. Attach Red and Blue warning labels to condenser and air handler as indicated.

### EZT-113B – Trap

11. Screw adaptor into drain outlet on primary drain pan, cut PVC stub to length & glue into adaptor (Figure 5).
12. Glue inlet Cross onto stub. Cross **MUST BE PLUMB.** (Figure 6). Open (uncapped) end of cross faces down.
13. Glue long end of U-Bend into bottom of Cross facing direction required, at least 5° off center (Figure 7).
14. Rotate outlet Tee in required direction and glue onto other end of U-Bend so that Red Cap faces up (Figure 8).
15. Glue condensate line from center leg of Tee to outside building (Figure 9).
16. Check for correct operation by pouring water into top opening of Cross (Figure 10). Horizontal Red Cap must remain in place during testing.
17. Replace Red Cap on top of inlet Cross and seat firmly (Figure 11). Red Caps are removable for cleaning and testing only. All Caps must remain closed during normal operation of the trap.
18. Place brush in retaining hole on Red Cap.
19. Attach Yellow cleaning label on air handler close to trap.

### IMPORTANT NOTES

1. BOTH DEVICES MUST BE INSTALLED STRICTLY IN ACCORDANCE WITH MANUFACTURER'S INSTRUCTIONS TO ENSURE PROPER OPERATION AND IN ACCORDANCE WITH ALL APPLICABLE LOCAL PLUMBING, DRAINAGE, AND/OR ELECTRICAL CODES.
2. THIS TRAP IS SUITABLE FOR USE ONLY IN DRAIN PANS WITH 3/4" OUTLET. **DO NOT USE ON LARGER SIZES** AS IT MAY NOT BE ABLE TO HANDLE HIGHER PRESSURES AND CONDENSATE FLOW FROM LARGER TONNAGE UNITS. CONSULT FACTORY FOR DETAILS ON LARGER TRAPS IF REQUIRED.
3. NOTE THAT DUE TO ITS PROXIMITY TO WATER, THIS SYSTEM IS SUITABLE FOR USE WITH 24 VOLT AC CURRENT ONLY. **DO NOT USE 110 VOLT AC IN THIS SYSTEM!!!**
4. **WARNING:** THE MICROSWITCH USED IN THIS MODEL HAS BEEN SPECIALLY MODIFIED TO MAKE IT MORE SENSITIVE TO THE RISE IN THE WATER LEVEL. IF IT NEEDS TO BE REPLACED, USE ONLY A GENUINE SPARE PART FROM THE MANUFACTURER. **DO NOT REPLACE WITH ANY OTHER MICROSWITCH. IT WILL NOT OPERATE CORRECTLY AND WILL INVALIDATE THE WARRANTY.**

